

PROPOSED G+IV STORIED RESIDENTIAL BUILDING PLAN OF HEIGHT 15.500 MT,
UNDER RAJPUR SONARPUR MUNICIPALITY RULE AT HOLDING NO. 510, BORAL
-C, WARD NO. 34, P.S.-NARENDRAPUR, KOLKATA-700154

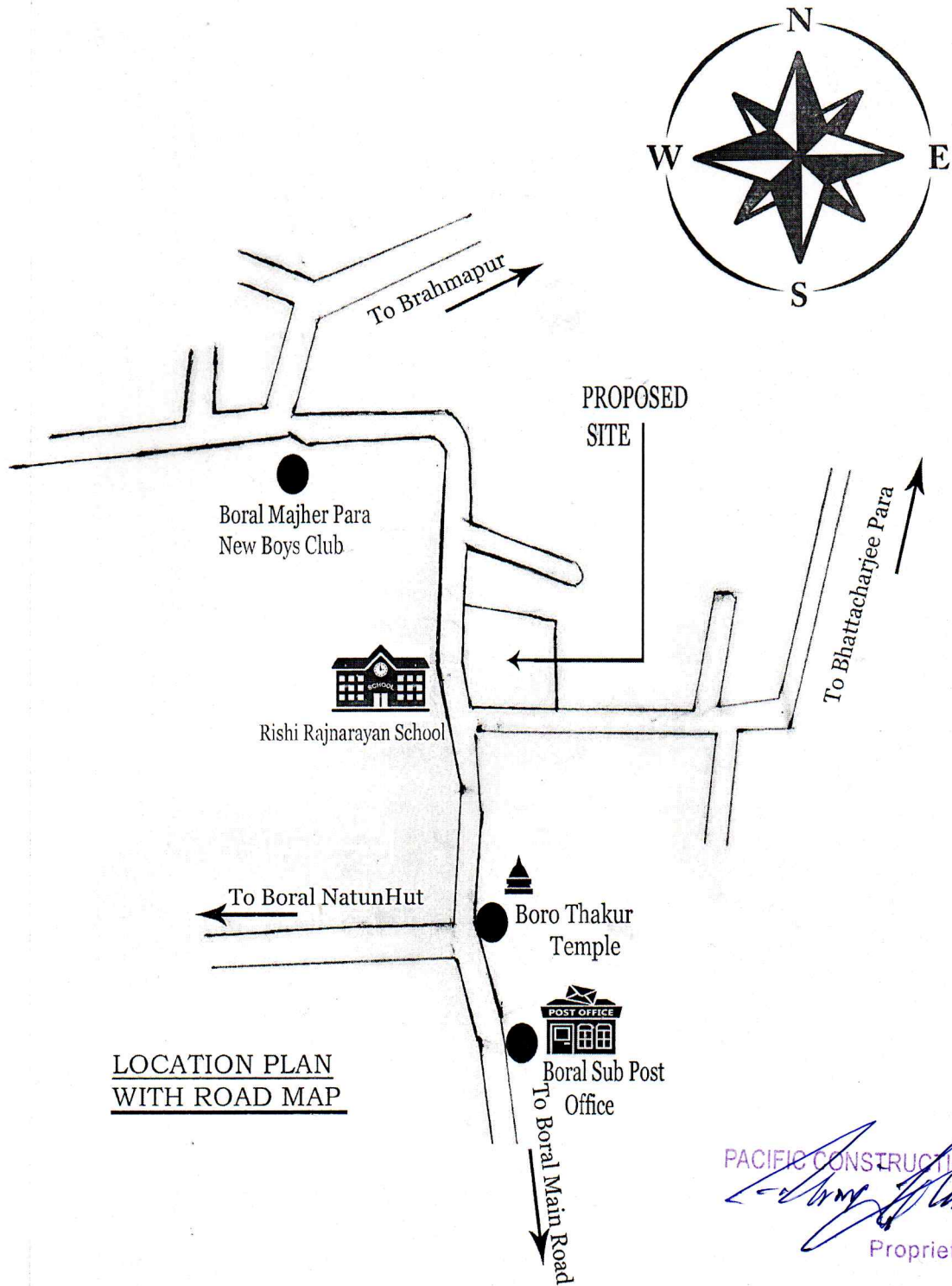

PACIFIC CONSTRUCTION
[Signature]
Proprietor

PROPOSED G+IV STORIED RESIDENTIAL BUILDING PLAN OF HEIGHT 15.500 MT,
UNDER RAJPUR SONARPUR MUNICIPALITY RULE AT HOLDING NO. 510, BORAL
-C, WARD NO. 34, P.S.-NARENDRAPUR, KOLKATA-700154

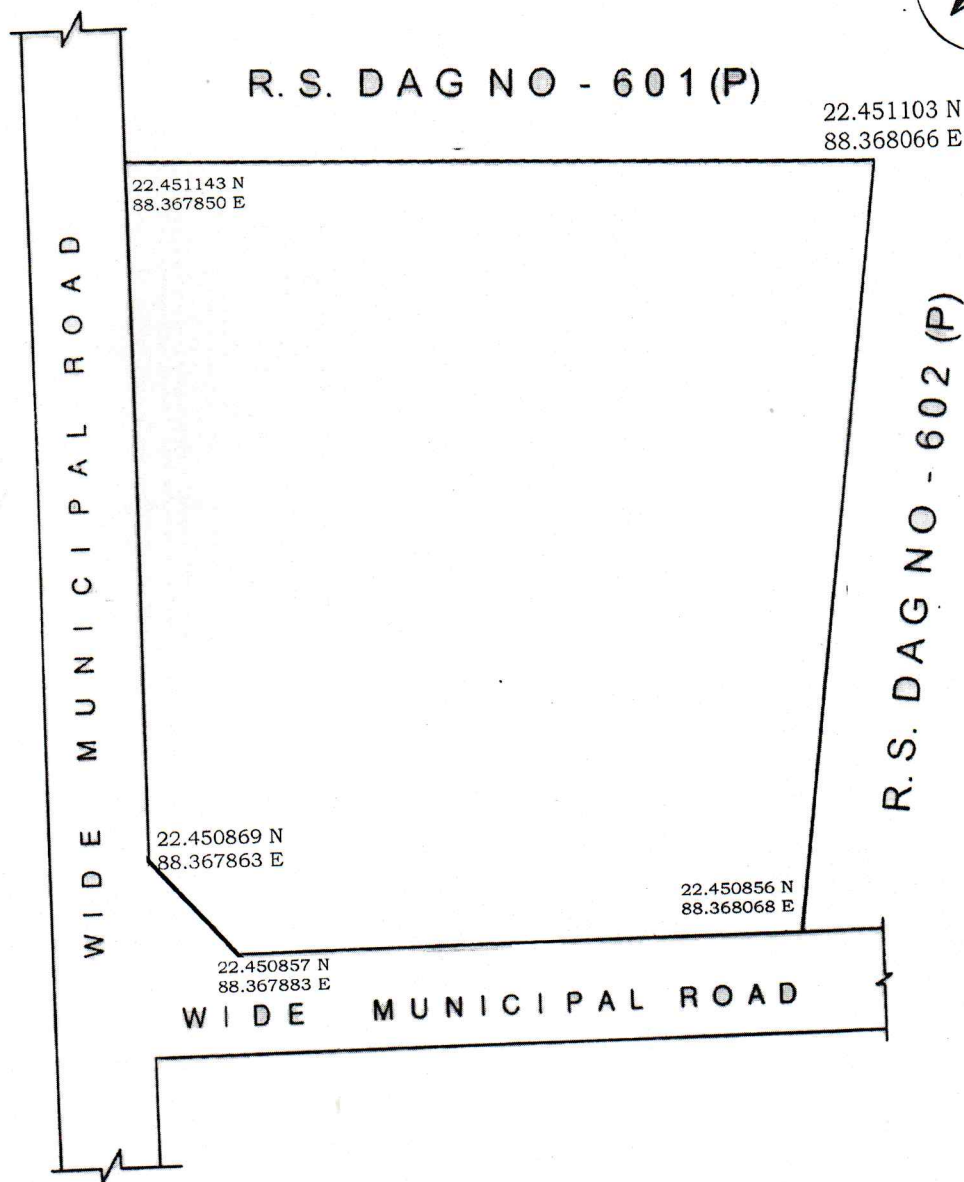
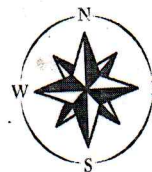

PACIFIC CONSTRUCTION
[Signature]
Proprietor

SITE PLAN WITH
LATITUDE LONGITUDE